

Soil Removal Report

Site: 93rd Street Elementary School
330 East 93rd Street
Los Angeles, California 90003

Prepared for
Los Angeles Unified School District



**Los Angeles Unified School District
Office of Environmental Health and Safety
333 South Beaudry Avenue, 21st Floor
Los Angeles, California 90017**

August 9, 2016

Prepared by

**PARSONS
100 WEST WALNUT STREET • PASADENA • CALIFORNIA 91124**

Signatures

This Soil Removal Report was prepared under the supervision of the following professionals.

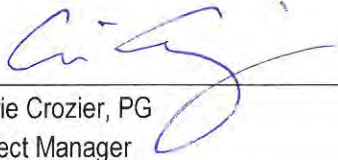

Carrie Crozier, PG
Project Manager

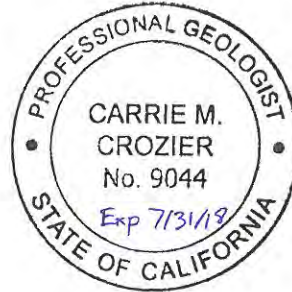

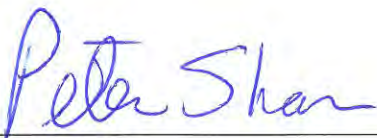

Pete Shair, PG
Project Geologist

Table of Contents

1. Introduction	1-1
2. Pre-field Activities.....	2-3
3. Soil Removal Activities.....	3-3
3.1 Backfill and Restoration.....	3-4
4. Conclusions and Recommendations.....	4-1
5. References.....	5-2

Attachments

Figures

- Figure 1 Site Vicinity Map
- Figure 2 Campus Map
- Figure 3 Site Plan
- Figure 4 Soil Removal Areas

Table

- Table 1 Summary of Soil Analytical Results

Appendices

- Appendix A Waste Manifests

List of Abbreviations and Acronyms

AIS	American Integrated Services
bgs	below ground surface
CalEPA	California Environmental Protection Agency
DTSC	Department of Toxic Substances Control
EPA	United States Environmental Protection Agency
ft	foot or feet
LAUSD	Los Angeles Unified School District
mg/L	milligrams per liter
mg/kg	milligrams per kilogram
OEHHA	Office of Environmental Health Hazard Assessment
PEAE	Preliminary Environmental Assessment Equivalent
Pinner	Pinner Construction
RCRA	Resources Conservation and Recovery Act
SSCG	Site Specific Cleanup Goals
STLC	Soluble Threshold Limit Concentration
TCLP	Toxicity Characteristic Leaching Procedure
UCL	Upper Confidence Limit
USA	Underground Service Alert

1. Introduction

Parsons has prepared this Soil Removal Report on behalf of the Los Angeles Unified School District (LAUSD). This report summarizes soil removal activities at the 93rd Street Elementary School at 330 East 93rd Street in Los Angeles, California. LAUSD's 93rd Street Elementary School campus (the Campus) is located at 330 East 93rd Street, Los Angeles, CA 90003. The Campus is bounded by 93rd Street to the north, Towne Avenue to the east, 95th Street to the south, and an alley to the west. Residential and commercial properties facing South San Pedro Street are located west of the alley (Figure 1). The School property is currently an active school site. The Campus consists of existing school buildings and playground areas. The Campus is on one parcel that is approximately 6.44 acres (Figure 2). A *Preliminary Environmental Assessment Equivalent* (PEAE) report was prepared by Parsons in June 2016, which evaluated a portion of the Campus scheduled for redevelopment (Site) for potential environmental impacts. The subject evaluation area (Site) is approximately 1.7 acres within the Campus footprint, encompassing the existing auditorium, kitchen, lunch pergola, and northwestern portion of the playground (Figure 3). Off-Site locations may be within the Campus but outside of the Site.

The Site was undeveloped until the 1920's, at which time the Campus appears to be under agricultural use (starting in the early 1920's). The property was initially used agriculturally, and residential structures were constructed at the Site by 1928. The residential structures were removed in the early 1960s, and the Campus was constructed in 1962. The adjacent properties have been primarily residential from the early 1920's through the present day (August 2016).

The PEAE found the presence of lead, arsenic, pesticides, in soil within the redevelopment area. Soil sampling and analyses was conducted as part of the PEAE, and two areas (Figure 4) were identified within the redevelopment area in which concentrations of arsenic or lead in soil exceeded acceptable levels for a school site. As discussed in the PEAE, Site specific cleanup goals (SSCG) were established based on the California Department of Toxic Substances Control (DTSC) and California Environmental Protection Agency (CalEPA) Office of Environmental Health Hazard Assessment (OEHHA) criteria for lead, arsenic, and pesticides in soil (DTSC, 2007; OEHHA, 2009; DTSC, 2015). All lead sample results were under the primary SSCG of a 95% Upper Confidence Limit (UCL) of 80 mg/kg lead in soil. One sample was above the secondary SSCG of 5 mg/L STLC for lead. One area was identified as containing soil with arsenic concentrations above the SSCG of 12 mg/kg. No soil samples contained pesticides above SSGCs and no further action is needed to address pesticides within the redevelopment area.

Per the request of LAUSD, soil was excavated and disposed offsite from two areas;

- 1) Area 1 – 8 foot (ft) by 8 ft area south of the old lunch shelter and east of the southern parking lot was excavated to 2.5 feet below ground surface (bgs) to remove lead impacted California-hazardous (i.e., non-Resource Conservation and Recovery [RCRA] hazardous) soil.

- 2) Area 2 – Approximately 3,227 square ft area on the south of the kitchen extending into the southern parking area to remove non-hazardous soil impacted with arsenic above levels acceptable for a school site.

Area 1

Soil from boring C4 at 2.0 ft bgs contained a concentration of 8.3 milligrams per liter (mg/L) soluble threshold limit concentration (STLC) for lead, which exceeds the Site Specific Cleanup Goal (SSCG) threshold of 5 mg/L. Toxic characteristic leaching procedure (TCLP) analytical results for the soil sample from boring C4 at 2.0 ft bgs were below the analytical laboratory detection limits. Based on the STLC result, soil at 2.0 ft bgs from boring C4 was identified as California-hazardous.

To define the California-hazardous soil, a step-down soil sample from boring C4 at 2.5 ft bgs was analyzed. The soil sample from 2.5 ft bgs in boring C4 yielded analytical results below SSCGs; defining the California-hazardous soil vertically in boring C4 as shallower than 2.5 ft bgs.

Four step-out borings were advanced four lateral feet from boring C4, and soil samples were collected at 6-inch intervals to 3 ft bgs. Samples from 2 ft bgs from each of the step-out borings were analyzed. Results from borings to the east (boring C4E), west (boring C4W), and south (boring C4S) yielded analytical results for lead below the SSCG. In the boring to the north (C4N) at 2.0 ft bgs, the sample results were 91 mg/kg lead and 0.79 mg/L STLC for lead. A step-down sample was analyzed from boring C4N at 2.5 ft bgs, and 4.3 mg/kg lead was reported. These results indicate that the non-RCRA hazardous soil is defined by borings C4E, C4W, C4S, and C4N (Figure 4).

Area 2

Soil sample B4 at 0.5 ft bgs contained 23 mg/kg of arsenic, exceeding the SSCG of 12 mg/kg. Step-out borings were advanced 4 feet to the north (boring B4N), east (boring B4E), west (boring B4W), and south (boring B4S) of boring B4. Boring B4S met refusal at approximately 1.1 ft bgs, and a second boring (B4S2) was advanced two feet south of boring B4. Samples were collected at 6-inch intervals to 3 ft bgs from each boring. All of the arsenic concentrations in soil samples from the step-out borings at 0.5 ft bgs exceeded the SSCG for arsenic (12 mg/kg) except boring B4S (10 mg/kg).

Additional step-out soil samples were collected halfway between the location of boring B4 and the next adjacent boring with a sample result below the SSCG. Arsenic concentrations in these step-out borings at 0.5 ft bgs were below the SSCG to the east and west (2.6 mg/kg in B4E2 and 8.0 mg/kg in B4W2, respectively) and above the SSCG to the north (21 mg/kg in B4N2). Arsenic in soil is defined by concentrations below the SSCG in boring B4S to the south, boring B4E2 to the east, boring B4W2 to the west, and boring B3 to the north (Figure 4).

Step-down samples from 1 ft bgs were analyzed to define arsenic in soil vertically. The step-down samples in B4 and the surrounding step-out borings ranged from 2.7 to 6.1 mg/kg. Arsenic is defined as only exceeding the SSCG in soil in the 0.5 ft bgs samples. STLC analysis was conducted on the sample with the highest arsenic concentration (B4S2 at 1 ft bgs), and resulted in a concentration of 0.15 mg/L STLC. The arsenic-impacted soil is considered non-hazardous.

2. Pre-field Activities

The proposed excavation areas were marked in white paint on July 5, 2016. Underground Services Alert (USA) was notified a minimum of 48 hours prior to initiating soil excavation. Parsons reviewed a map of underground utility lines identified in the excavation area by Pacific Coast Locators, a private utility locator. The area was cleared for the presence of underground utilities using geophysical methods (including ground-penetrating radar, electromagnetic utility locating, and deep search metal detector), on December 31, 2015. The contractor for the school improvement project, Pinner Construction (Pinner), removed the pavement from the two excavation areas prior to remediation contractor mobilization.

3. Soil Removal Activities

The soil removal work occurred when school was closed to students for summer break. Soil excavation activities were conducted on July 11 and 12, 2016. Parsons supervised American Integrated Services, Inc. (AIS) who operated the equipment required to excavate and transport soil.

Soil excavation consisted of the removal of lead-impacted soil to a depth of 2.5 ft bgs in Area 1 and arsenic-impacted soil to a depth of 12 inches bgs in Area 2 (Figure 4).

Waste characterization to support soil disposal was conducted based on analytical results from soil samples collected prior to excavation. The samples were analyzed for lead and arsenic using United States Environmental Protection Agency (EPA) Method 6010B. In addition, STLC and TCLP results were used to characterize the waste. Based on the analytical results from samples collected, the lead-impacted soil was characterized as California-hazardous waste. The arsenic-impacted soil was characterized as non-hazardous waste.

A total of approximately 13.82 tons of California (non-RCRA) hazardous waste and 153.1 tons of non-hazardous soil was removed during the excavation. Waste manifests and weight tickets are provided in Appendix A. The non-RCRA excavated soil was directly loaded into trucks for immediate transport and off-site disposal. Materials characterized as non-RCRA hazardous were transported under Uniform Hazardous Waste Manifest. Transportation of the soil was provided by AIS to the disposal facility at South Yuma County Landfill in Arizona. A total of one truck transported soils to this landfill.

A total of approximately 153.1 tons of non-hazardous soil was removed during the excavation. Non-hazardous soil was temporarily stockpiled and loaded into trucks for transportation to Chiquita Canyon Landfill by AIS. Waste manifests and weight tickets are provided in Appendix A. All of the waste material was managed as required by local, state, and federal guidance.

3.1 Backfill and Restoration

Area 1 was temporarily backfilled with soil from within the PEAE assessment area to prevent falling hazards for Site workers. Soil was not compacted because the school improvement contractor, Pinner, indicated that prior to construction the area would be excavated to a greater depth than the remedial excavation and then backfilled with certified compaction.

Similar to Area 1, Area 2 was not backfilled, as Pinner indicated that the area would be regraded prior to upcoming construction. No pavement was replaced in Area 1 or Area 2.

4. Conclusions and Recommendations

Based on the laboratory analytical results of the soil samples used to define the soil removal areas, the following conclusions are made:

Soil impacted with lead and arsenic above their respective SSCGs was removed in order to limit potential exposure to these compounds. A total of approximately 166.92 tons of soil was excavated and removed during soil removal activities. The arsenic-impacted area was excavated to 12 inches bgs. The lead-impacted area was excavated to a depth of 2.5 ft bgs. Soil with elevated concentrations of lead or arsenic identified during the sampling events has been removed offsite and properly disposed. No further action is necessary with respect to the areas that are the subject of this report.

5. References

Department of Toxic Substances Control (DTSC), 2007. Determination of a Southern California Regional Background Arsenic Concentration in Soil.

Department of Toxic Substances Control (DTSC - EnviroStor), 2015. Information about sites in the vicinity and Site cleanup activities. October.

Office of Environmental Health Hazard Assessment, Integrated Risk Assessment Branch, California Environmental Protection Agency, 2009. Revised California Human Health Screening Levels for Lead.

Parsons, 2016. Preliminary Environmental Assessment Equivalent (PEAE). June.

Figures

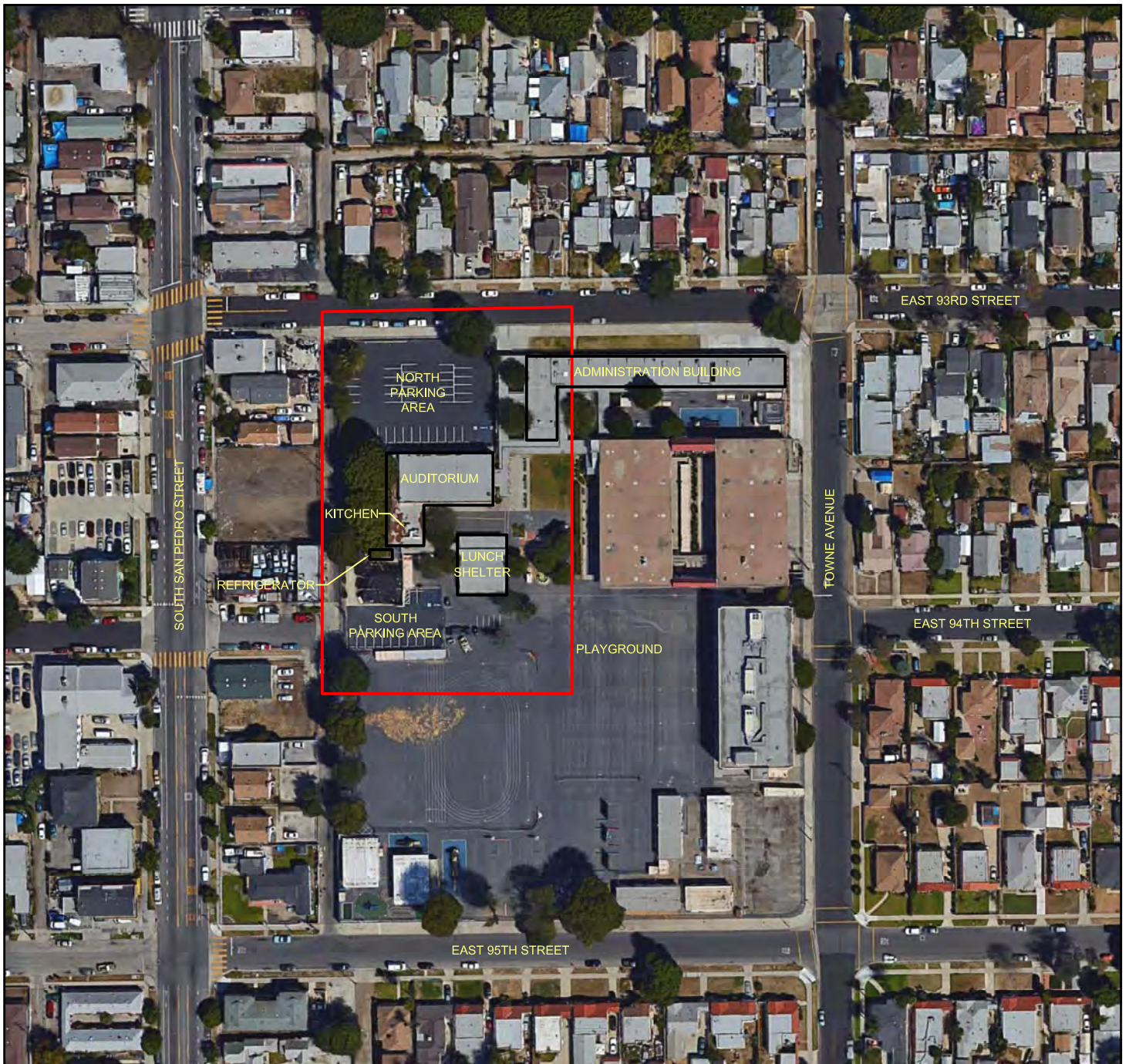

Note: Base Map from Google Earth Pro, 2016.

LEGEND

- Building outline
- Outline of area shown in Figure 3



0 150 300



FEET

PARSONS

Figure 2
Campus Map

LAUSD
93rd Street Elementary School
330 East 93rd Street
Los Angeles, CA 90003

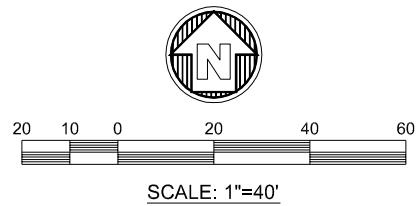

LEGEND :

- FENCE
- FENCE
- FENCE
- BORING LOCATION
- ABOVE GRADE PLANTER

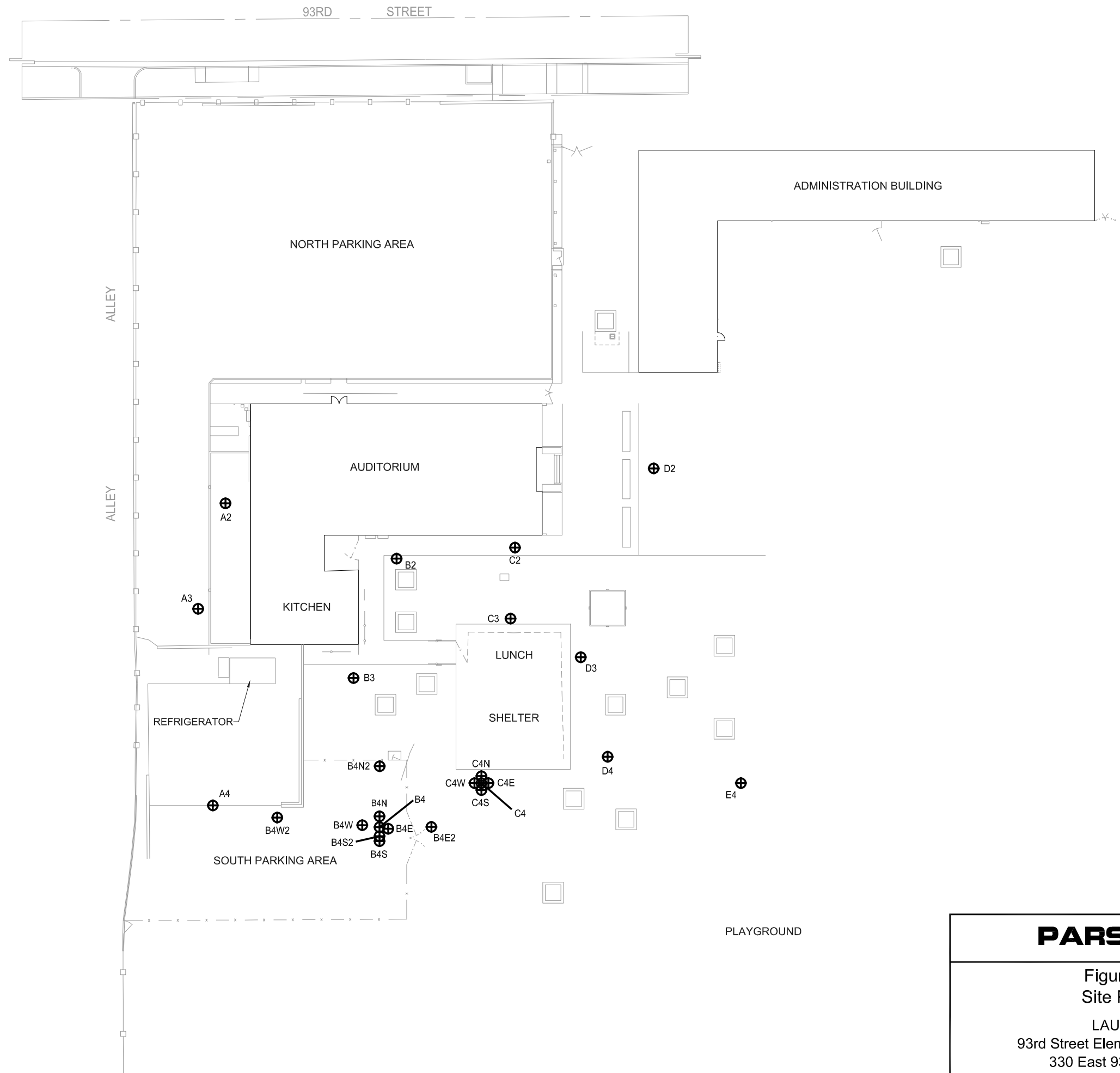

Source: Site plan provided by P.A. Arca Engineering, Inc.

PARSONS

Figure 3
Site Plan

LAUSD
93rd Street Elementary School
330 East 93rd Street
Los Angeles, CA 90003

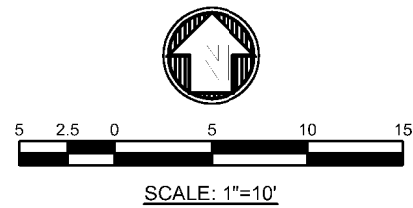

LEGEND :

- FENCE
- FENCE
- FENCE
- BORING LOCATION
- ABOVE GRADE PLANTER

REFRIGERATOR

SOUTH PARKING AREA

AREA 2: ARSENIC REMOVAL AREA

AREA 1: LEAD REMOVAL AREA

LUNCH
SHELTER

D3

Source: Site plan provided by P.A. Arca Engineering, Inc.

Figure 4
Soil Removal Areas
LAUSD
93rd Street Elementary School
330 East 93rd Street
Los Angeles, CA 90003

Table

Table 1
Summary of Soil Analytical Results
93rd Street Elementary School
330 E 93rd Street
Los Angeles, California

Sample Location	Depth (ft below grade)	Sample Collection Date	Lead	Lead STLC	Lead TCLP	Arsenic	Arsenic STLC
SSCG			80	5	5	12	5
Units			mg/kg	mg/L	mg/L	mg/kg	mg/L
A2-0.5	0.5	1/8/2016	24	--	--	8.3	--
A3-0.5	0.5	1/8/2016	61	--	--	7.3	--
A3-2.0	2.0	1/8/2016	39	--	--	6.9	--
A4-0.5	0.5	1/8/2016	8.6	--	--	11	--
A4-2.0	2.0	1/8/2016	4.7	--	--	6.2	--
B2-0.5	0.5	1/8/2016	77	--	--	6.1	--
B2-0.5D	0.5	1/8/2016	20	--	--	5.0	--
B3-0.5	0.5	1/8/2016	35	--	--	5.0	--
B3-2.0	2.0	1/8/2016	9.7	--	--	5.8	--
B4-0.5	0.5	1/8/2016	14	--	--	23	--
B4-1.0	1.0	1/8/2016	--	--	--	5.9	--
B4-2.0	2.0	1/8/2016	18	--	--	6.0	--
B4N-0.5	0.5	1/18/2016	--	--	--	17	--
B4N-1.0	1.0	1/18/2016	--	--	--	6.1	--
B4N2-0.5	0.5	2/6/2016	--	--	--	21	--
B4N2-1.0	1.0	2/6/2016	--	--	--	4.3	--
B4E-0.5	0.5	1/18/2016	--	--	--	21	--
B4E-1.0	1.0	1/18/2016	--	--	--	2.7	--
B4E2-0.5	0.5	2/6/2016	--	--	--	2.6	--
B4S-0.5	0.5	1/18/2016	--	--	--	10	--
B4S2-0.5	0.5	1/18/2016	--	--	--	60	0.15
B4S2-1.0	1.0	1/18/2016	--	--	--	5.3	--
B4W-0.5	0.5	1/18/2016	--	--	--	19	--
B4W-1.0	1.0	1/18/2016	--	--	--	3.5	--
B4W2-0.5	0.5	2/6/2016	--	--	--	8.0	--
C2-0.5	0.5	1/8/2016	39	--	--	4.8	--
C2-2.0	2.0	1/8/2016	30	--	--	6.3	--
C3-0.5	0.5	1/8/2016	76	--	--	6.1	--
C3-0.5D	0.5	1/8/2016	27	--	--	5.6	--
C3-2.0	2.0	1/8/2016	28	--	--	6.9	--

Table 1
Summary of Soil Analytical Results
93rd Street Elementary School
330 E 93rd Street
Los Angeles, California

Sample Location	Depth (ft below grade)	Sample Collection Date	Lead	Lead STLC	Lead TCLP	Arsenic	Arsenic STLC
SSCG			80	5	5	12	5
Units			mg/kg	mg/L	mg/L	mg/kg	mg/L
C4-0.5	0.5	1/8/2016	40	--	--	7.2	--
C4-2.0	2.0	1/8/2016	83	8.3	ND<0.080	7.7	--
C4-2.5	2.5	1/8/2016	9.3	--	--	--	--
C4N-2.0	2.0	2/6/2016	91	0.79	--	--	--
C4N2.5	2.5	2/6/2016	4.3	--	--		
C4W-2.0	2.0	2/6/2016	24	--	--	--	--
C4E-2.0	2.0	2/6/2016	27	--	--	--	--
C4S-2.0	2.0	2/6/2016	28	--	--	--	--
D2-0.5	0.5	1/8/2016	46	--	--	4.6	--
D2-2.0	2.0	1/8/2016	28	--	--	5.7	--
D3-0.5	0.5	1/8/2016	110	0.82	--	5.3	--
D3-1.0	1.0	1/8/2016	24	--	--	--	--
D4-0.5	0.5	1/8/2016	40	--	--	9.4	--
D4-2.0	2.0	1/8/2016	13	--	--	4.7	--
E4-0.5	0.5	1/8/2016	38	--	--	6.3	--

Notes:

-- = not analyzed

mg/kg = milligrams per kilogram

mg/L - micrograms per liter

SSCG = Site Specific Cleanup Goals

ND = not detected

 = concentration exceeds SSCG

Appendix A.



LAUSD
93rd Street Elementary School
Los Angeles, CA 90003

Date	Load	Manifest No.	Weight Ticket	Description	Tons
7/12/16	1	001-36174	913921	Non Hazardous Soil	22.68
7/12/16	1	002-36174	913997	Non Hazardous - Soil	27.74
7/12/16	1	003-36174	914104	Non Hazardous - Soil	24.74
7/12/16	1	004-36174	914161	Non Hazardous - Soil	26.01
7/12/16	1	005-36174	914515	Non Hazardous - Soil	25.39
7/12/16	1	006-36174	914808	Non Hazardous - Soil	26.54
Load Count	6			Total Tons (Non-Hazardous Soil):	153.10

Date	Load	Manifest No.	Weight Ticket	Description	Tons
7/12/16	1	014955569	1168999	Non-RCRA Hazardous Soil	13.82
Load Count	1			Total Tons (Non-RCRA Soil)	13.82

UNIFORM HAZARDOUS WASTE MANIFEST		1. Generator ID Number CAR000195859		2. Page 1 of 1	3. Emergency Response Phone 888-423-6080		4. Manifest Tracking Number 014955569 JJK	
		5. Generator's Name and Mailing Address Los Angeles Unified School District - OEHS 333 S. Deaudry Ave., 21st Floor, Los Angeles, CA 90017 (213) 241-3198		Generator's Site Address (if different than mailing address) LAUSD - 63rd Street Elementary School 330 63rd Street Los Angeles, CA 90003				
6. Transporter 1 Company Name American Integrated Services		(310) 522-1168		U.S. EPA ID Number CAR000148338				
7. Transporter 2 Company Name				U.S. EPA ID Number				
8. Designated Facility Name and Site Address South Yuma County Landfill 18638 South Avenue 1E, Yuma, AZ. 85365 (928) 341-8300				U.S. EPA ID Number AZR000508980				
Facility's Phone:								
9a. HM	9b. U.S. DOT Description (including Proper Shipping Name, Hazard Class, ID Number, and Packing Group (if any))			10. Containers No. Type		11. Total Quantity	12. Unit Wt./Vol.	13. Waste Codes
1.	Non-RCRA Hazardous Waste Solid (Soil w/ Land)			21225 DT		10	Y	611
2.								
3.								
4.								
14. Special Handling Instructions and Additional Information Soil: 85 - 100% Debris: 0 - 1% Wear appropriate PPE while handling								
SYCL Profile: C-3791 AIS Project#: 30174								
15. GENERATOR'S/OFFEROR'S CERTIFICATION: I hereby declare that the contents of this consignment are fully and accurately described above by the proper shipping name, and are classified, packaged, marked and labeled/placarded, and are in all respects in proper condition for transport according to applicable international and national governmental regulations. If export shipment and I am the Primary Exporter, I certify that the contents of this consignment conform to the terms of the attached EPA Acknowledgment of Consent. I certify that the waste minimization statement identified in 40 CFR 262.27(a) (if I am a large quantity generator) or (b) (if I am a small quantity generator) is true.								
Generator's/Offeror's Printed/Typed Name on behalf of LAUSD - OEHS				Signature 		Month Day Year 7 12 16		
16. International Shipments <input type="checkbox"/> Import to U.S. <input type="checkbox"/> Export from U.S. Port of entry/exit: _____ Transporter signature (for exports only): _____ Date leaving U.S.: _____								
17. Transporter Acknowledgment of Receipt of Materials								
Transporter 1 Printed/Typed Name ALFONSO SANDOVAL				Signature 		Month Day Year 7 12 16		
Transporter 2 Printed/Typed Name				Signature		Month Day Year		
18. Discrepancy								
18a. Discrepancy Indication Space <input type="checkbox"/> Quantity <input type="checkbox"/> Type <input type="checkbox"/> Residue <input type="checkbox"/> Partial Rejection <input type="checkbox"/> Full Rejection Manifest Reference Number: _____								
18b. Alternate Facility (or Generator) U.S. EPA ID Number _____								
Facility's Phone: _____								
18c. Signature of Alternate Facility (or Generator) Month Day Year								
19. Hazardous Waste Report Management Method Codes (i.e., codes for hazardous waste treatment, disposal, and recycling systems)								
1.		2.		3.		4.		
20. Designated Facility Owner or Operator: Certification of receipt of hazardous materials covered by the manifest except as noted in Item 18a								
Printed/Typed Name NOBUHI KINOKA				Signature 		Month Day Year 7 12 16		

SOUTH YUMA COUNTY LANDFILL

PO BOX 125; Staton, CA 90680-0125

928-341-9300

ACCOUNT#: AMERICAN I

TRANSACTION INFORMATION

AMERICAN INTEGRATED SERVICES INC.
P.O. BOX 92316

TICKET# : 1168999

DATE IN : 7/12/2016 TIME IN : 02:32 PM

DATE OUT: 7/12/2016 TIME OUT: 02:32 PM

LONG BEACH, CA90809-2316

JOB #: C-3791

HAULER: INDEPENDENT HAULERS

TRUCK # : G.S 101

TRUCK LICENSE #:

CONTAINER #:

PLEASE NOTE: Account Customers Only: A State of Arizona per ton landfill fee of
\$0.25 will be added to your Inv.

REFUSE WEIGHT IN WEIGHT OUT NET WEIGHT

NON -HAZ SOIL 57800 LBS 30160 LBS 13.82 TONS

CUSTOMER SIGNATURE

WEIGHMASTER/DEPUTY

PUBLIC WEIGHMASTER'S CERTIFICATE OF WEIGHT AND MEASURE

THIS IS TO CERTIFY that the above described merchandise, was weighed, counted,
or measured by the public or deputy weighmaster, and when properly signed, and
sealed, shall be prima facie evidence of the accuracy of the weight shown as
prescribed by law. form-m

AGT-21

GENERATOR	NON-HAZARDOUS WASTE MANIFEST		1. Generator ID Number Not Required		2. Page 1 of 1		3. Emergency Response Phone 888-423-6080		4. Waste Tracking Number 001 - 36174			
	5. Generator's Name and Mailing Address Los Angeles Unified School District - OEHS 333 S. Beaudry Ave., 21st Floor, Los Angeles, CA 90017 (213) 241-3199						Generator's Site Address (if different than mailing address) LAUSD - 93rd Street Elementary School 330 E. 93rd Street Los Angeles, California 90003					
	6. Transporter 1 Company Name Giosand						U.S. EPA ID Number					
	7. Transporter 2 Company Name						U.S. EPA ID Number					
	8. Designated Facility Name and Site Address Chiquita Canyon Landfill 28201 Henry Mayo Drive, Castaic, CA 91384 Facility's Phone: (661) 257-3655						U.S. EPA ID Number Not Required					
	9. Waste Shipping Name and Description		10. Containers		11. Total Quantity	12. Unit Wt./Vol.						
			No.	Type								
	1. Non-Hazardous Waste Solid (Soil)		001	DT	18	Y						
	2.											
	3.											
4.												
13. Special Handling Instructions and Additional Information Soil: 99-100% CCL Profile No.: CCL-16-137 Acct. No.: 1692 AIS Project #: 36174 Debris: 0-1% Wear appropriate PPE when handling or as necessary												
14. GENERATOR'S/OFFEROR'S CERTIFICATION: I hereby declare that the contents of this consignment are fully and accurately described above by the proper shipping name, and are classified, packaged, marked and labeled/placarded, and are in all respects in proper condition for transport according to applicable international and national governmental regulations.												
Generator's/Offor's Printed/Typed Name Carrie Crozier on behalf of LAUSD - OEHS												
Signature <i>Carrie Crozier</i>												
Month Day Year 17 12 16												
INT'L	15. International Shipments <input type="checkbox"/> Import to U.S. <input type="checkbox"/> Export from U.S. Port of entry/exit: Date leaving U.S.:											
	16. Transporter Acknowledgment of Receipt of Materials											
TRANSPORTER	Transporter 1 Printed/Typed Name Derrick McDaniel											
	Signature <i>Derrick McDaniel</i>											
Month Day Year 17 12 16												
Transporter 2 Printed/Typed Name												
Signature												
Month Day Year												
DESIGNATED FACILITY	17. Discrepancy											
	17a. Discrepancy Indication Space <input type="checkbox"/> Quantity <input type="checkbox"/> Type <input type="checkbox"/> Residue <input type="checkbox"/> Partial Rejection <input type="checkbox"/> Full Rejection											
	Manifest Reference Number:											
	17b. Alternate Facility (or Generator) U.S. EPA ID Number											
	Facility's Phone:											
17c. Signature of Alternate Facility (or Generator)												
Month Day Year												
18. Designated Facility Owner or Operator: Certification of receipt of materials covered by the manifest except as noted in Item 17a												
Printed/Typed Name												
Signature												
Month Day Year 17 12 16												



1592
AMERICAN INTEGRATED SERVICES
ATTN: ACCOUNTS PAYABLE
PO BOX 92316
LONG BEACH, CA 90809

SITE	TICKET	GRID		WEIGHMASTER	
01	913921			DOLORESL	
DATE IN	DATE OUT	TIME IN	TIME OUT	VEHICLE	ROLL OFF
07/12/16	07/12/16	11:39	11:39	A-GT21	
REFERENCE		ORIGIN			
16-137		LOS ANGELES			

Scale Gross Wt.	72020					
Stored Tare Wt.	26660	Charge Ticket				
Net Weight	45360					
QTY.	UNIT	DESCRIPTION	RATE	EXTENSION	FEE	TOTAL
22.68	TON	Soil - Non Hazardous				

Operating Hours:M-F 4:30AM to 5:00 PM, Sat 4:30AM-2:00PM
Sunday-Closed
I am responsible for damage and injuries.
Load has no liquids or hazardous waste

Note1: LAUSD
Note2: OEHS, 330 E. 3RD ST
Route: LOS ANGELES, CA 90003
PO Number 001 36174

SIGNATURE: _____

NET AMOUNT
TENDERED
CHANGE
CHECK NO.

GENERATOR

INT'L

TRANSPORTER

DESIGNATED FACILITY

NON-HAZARDOUS
WASTE MANIFEST

1. Generator ID Number

Not Required

2. Page 1 of

1

3. Emergency Response Phone

888-423-8080

4. Waste Tracking Number

002 - 36174

5. Generator's Name and Mailing Address

Los Angeles Unified School District - OEHS
333 S. Beaudry Ave., 21st Floor, Los Angeles, CA 90017
(213) 241-3198

Generator's Site Address (if different than mailing address)

LAUSD - 93rd Street Elementary School
330 E. 93rd Street
Los Angeles, California 90003

Generator's Phone:

6. Transporter 1 Company Name

GIO SAND

U.S. EPA ID Number

7. Transporter 2 Company Name

U.S. EPA ID Number

8. Designated Facility Name and Site Address

Chiquita Canyon Landfill
28201 Henry Mayo Drive, Castaic, CA 91384

U.S. EPA ID Number

Facility's Phone: (661) 257-3855

Not Required

9. Waste Shipping Name and Description

10. Containers

No.

Type

11. Total
Quantity12. Unit
Wt./Vol.

1.

Non-Hazardous Waste Solid (Soil)

001

DT

18

Y

2.

3.

4.

13. Special Handling Instructions and Additional Information

Soil: 99-100%

CCL Profile No.: CCL-10-137

Acc. No.: 1592

AIS Project #: 36174

Debris: 0-1%

Wear appropriate PPE when handling or as necessary

14. GENERATOR'S/OFFEROR'S CERTIFICATION: I hereby declare that the contents of this consignment are fully and accurately described above by the proper shipping name, and are classified, packaged, marked and labeled/placarded, and are in all respects in proper condition for transport according to applicable international and national governmental regulations.

Generator's/Offor's Printed/Typed Name

Signature

Month Day Year

on behalf of LAUSD - OEHS

17 | 12 | 16

15. International Shipments

☐ Import to U.S.☐ Export from U.S.

Port of entry/exit:

Transporter Signature (for exports only):

Date leaving U.S.:

16. Transporter Acknowledgment of Receipt of Materials

Transporter 1 Printed/Typed Name

Signature

Month Day Year

LUIS CAR BAJAL

17 | 12 | 16

Transporter 2 Printed/Typed Name

Signature

Month Day Year

17. Discrepancy

17a. Discrepancy Indication Space

☐ Quantity☐ Type☐ Residue☐ Partial Rejection☐ Full Rejection

Manifest Reference Number:

17b. Alternate Facility (or Generator)

U.S. EPA ID Number

Facility's Phone:

17c. Signature of Alternate Facility (or Generator)

Month Day Year

18. Designated Facility Owner or Operator: Certification of receipt of materials covered by the manifest except as noted in Item 17a

Printed/Typed Name

Signature

Month Day Year

Alexa

17 | 12 | 16



1592
AMERICAN INTEGRATED SERVICES
ATTN: ACCOUNTS PAYABLE
PO BOX 92316
LONG BEACH, CA 90809

SITE	TICKET	GRID		WEIGHMASTER		
01	913997			DOLORESL		
DATE IN	DATE OUT	TIME IN	TIME OUT	VEHICLE	ROLL OFF	
07/12/16	07/12/16	12:38	12:38	A-100		
REFERENCE		ORIGIN				
16-137		LOS ANGELES				



Scale Gross Wt.	83020					
Stored Tare Wt.	27540	Charge Ticket				
Net Weight	55480					
QTY.	UNIT	DESCRIPTION	RATE	EXTENSION	FEE	TOTAL
27.74	TON	Soil - Non Hazardous				

Note1: LAUSD
Note2: OEHS, 330 E. 3RD ST
Route: LOS ANGELES, CA 90003
PO Number: 002-36174

SIGNATURE:

	NET AMOUNT
	TENDERED
	CHANGE
	CHECK NO.

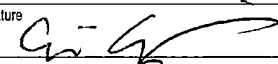
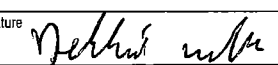
A 64-21

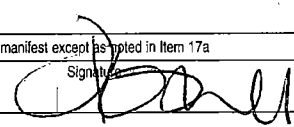
NON-HAZARDOUS WASTE MANIFEST		1. Generator ID Number Not Required	2. Page 1 of 1	3. Emergency Response Phone 888-423-6080	4. Waste Tracking Number 003 - 36174
5. Generator's Name and Mailing Address Los Angeles Unified School District - OEHS 333 S. Beaudry Ave., 21st Floor, Los Angeles, CA 90017 (213) 241-3199			Generator's Site Address (if different than mailing address) LAUSD - 93rd Street Elementary School 330 E. 93rd Street Los Angeles, California 90003		
6. Transporter 1 Company Name Grosand			U.S. EPA ID Number		
7. Transporter 2 Company Name			U.S. EPA ID Number		
8. Designated Facility Name and Site Address Chiquita Canyon Landfill 29201 Henry Mayo Drive, Castaic, CA 91384 (661) 257-3655			U.S. EPA ID Number Not Required		
9. Waste Shipping Name and Description		10. Containers		11. Total Quantity	12. Unit Wt./Vol.
		No.	Type		
1. Non-Hazardous Waste Solid (Soil)		001	DT	18	Y
2.					
3.					
4.					
13. Special Handling Instructions and Additional Information Soil: 99-100% CCL Profile No.: CCL-16-137 Acct. No.: 1592 AIS Project #: 36174 Debris: 0-1% Wear appropriate PPE when handling or as necessary					
14. GENERATOR'S/OFFEROR'S CERTIFICATION: I hereby declare that the contents of this consignment are fully and accurately described above by the proper shipping name, and are classified, packaged, marked and labeled/placarded, and are in all respects in proper condition for transport according to applicable international and national governmental regulations.					
Generator's/Offor's Printed/Typed Name CARRIE CROZIER on behalf of LAUSD - OEHS			Signature 		Month Day Year 7 12 16
15. International Shipments <input type="checkbox"/> Import to U.S. <input type="checkbox"/> Export from U.S. Port of exit/exit: Date leaving U.S.:					
16. Transporter Acknowledgment of Receipt of Materials					
Transporter 1 Printed/Typed Name Derrick McDaniels			Signature 		Month Day Year 7 12 16
Transporter 2 Printed/Typed Name			Signature		Month Day Year
17. Discrepancy					
17a. Discrepancy Indication Space <input type="checkbox"/> Quantity <input type="checkbox"/> Type <input type="checkbox"/> Residue <input type="checkbox"/> Partial Rejection <input type="checkbox"/> Full Rejection					
17b. Alternate Facility (or Generator) Manifest Reference Number: U.S. EPA ID Number:					
17c. Signature of Alternate Facility (or Generator) Month Day Year					
18. Designated Facility Owner or Operator: Certification of receipt of materials covered by the manifest except as noted in Item 17a					
Printed Name 			Signature 		Month Day Year 7 18 16



1592
AMERICAN INTEGRATED SERVICES
ATTN: ACCOUNTS PAYABLE
PO BOX 92316
LONG BEACH, CA 90809

SITE	TICKET	GRID		WEIGHMASTER	
01	914104			ROSAL	
DATE IN	DATE OUT	TIME IN	TIME OUT	VEHICLE	ROLL OFF
07/12/16	07/12/16	14:39	14:39	A-GT21	
REFERENCE		ORIGIN			
16-137		LOS ANGELES			

Scale Gross Wt.	76140					
Stored Tare Wt.	26660	Charge Ticket				
Net Weight	49480					
QTY.	UNIT	DESCRIPTION	RATE	EXTENSION	FEE	TOTAL
24.74	TON	Soil - Non Hazardous				

Operating Hours:M-F 4:30AM to 5:00 PM, Sat 4:30AM-2:00PM
Sunday-Closed
I am responsible for damage and injuries.
Load has no liquids or hazardous waste

Note1: LAUSD
Note2: OEHS, 330 E. 3RD ST
Route: LOS ANGELES, CA 90003
PO Number 003-36174

SIGNATURE: _____

NET AMOUNT
TENDERED
CHANGE
CHECK NO.

GENERATOR

INT'L

TRANSPORTER

DESIGNATED FACILITY

NON-HAZARDOUS
WASTE MANIFEST

1. Generator ID Number

Not Required

2. Page 1 of
13. Emergency Response Phone
888-423-6080

4. Waste Tracking Number

004 - 36174

5. Generator's Name and Mailing Address

Los Angeles Unified School District - OEHS
333 S. Beaudry Ave., 21st Floor, Los Angeles, CA 90017
(213) 241-3199

Generator's Site Address (if different than mailing address)

LAUSD - 93rd Street Elementary School
330 E. 93rd Street
Los Angeles, California 90003

6. Transporter 1 Company Name

GIO SAND

U.S. EPA ID Number

7. Transporter 2 Company Name

U.S. EPA ID Number

8. Designated Facility Name and Site Address

Chiquila Canyon Landfill
29201 Henry Mayo Drive, Castaic, CA 91384

U.S. EPA ID Number

Facility's Phone: (661) 257-3655

Not Required

9. Waste Shipping Name and Description

10. Containers

No.

Type

11. Total
Quantity12. Unit
Wt./Vol.1.
Non-Hazardous Waste Solid (Soil)

001

DT

18

Y

2.

3.

4.

13. Special Handling Instructions and Additional Information

Soil: 99-100%

CCL Profile No.: CCL-16-137

Acct. No.: 1592

AIS Project #: 36174

Debris: 0-1%

Wear appropriate PPE when handling or as necessary

14. GENERATOR'S/OFFEROR'S CERTIFICATION: I hereby declare that the contents of this consignment are fully and accurately described above by the proper shipping name, and are classified, packaged, marked and labeled/placarded, and are in all respects in proper condition for transport according to applicable international and national governmental regulations.

Generator's/Offor's Printed/Typed Name

Signature

Month Day Year

CARRIE CROZIER on behalf of LAUSD - OEHS

Cris G

7 12 16

15. International Shipments

☐ Import to U.S.☐ Export from U.S.

Port of entry/exit:

Date leaving U.S.:

Transporter Signature (for exports only):

16. Transporter Acknowledgment of Receipt of Materials

Transporter 1 Printed/Typed Name

Signature

Month Day Year

LUIS CARBAJAL

Luis C

7 12 16

Transporter 2 Printed/Typed Name

Signature

Month Day Year

17. Discrepancy

17a. Discrepancy Indication Space

☐ Quantity☐ Type☐ Residue☐ Partial Rejection☐ Full Rejection

Manifest Reference Number:

17b. Alternate Facility (or Generator)

U.S. EPA ID Number

Facility's Phone:

17c. Signature of Alternate Facility (or Generator)

Month Day Year

18. Designated Facility Owner or Operator: Certification of receipt of materials covered by the manifest except as noted in Item 17a

Printed/Typed Name

Signature

Month Day Year

[Signature]

[Signature]

7 12 16



SITE	TICKET	GRID		WEIGHMASTER	
01	914161			ROSAL	
DATE IN	DATE OUT	TIME IN	TIME OUT	VEHICLE	ROLL OFF
07/12/16	07/12/16	16:13	16:13	A-100	
REFERENCE		ORIGIN			
16-137		LOS ANGELES			



CHECK NO.

GS101

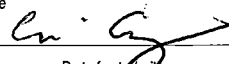
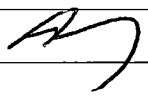
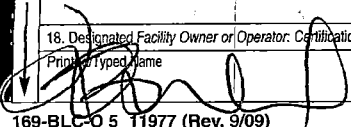
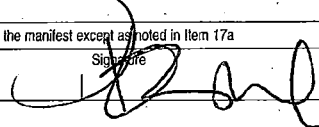
NON-HAZARDOUS WASTE MANIFEST		1. Generator ID Number Not Required	2. Page 1 of 1	3. Emergency Response Phone 888-423-6080	4. Waste Tracking Number 005 - 36174
5. Generator's Name and Mailing Address Los Angeles Unified School District - OEHS 333 S. Beaudry Ave., 21st Floor, Los Angeles, CA 90017 (213) 241-3199			Generator's Site Address (if different than mailing address) LAUSD - 93rd Street Elementary School 330 E. 93rd Street Los Angeles, California 90003		
6. Transporter 1 Company Name GIOSAND TRANSPORT			U.S. EPA ID Number		
7. Transporter 2 Company Name			U.S. EPA ID Number		
8. Designated Facility Name and Site Address Chiquita Canyon Landfill 29201 Henry Mayo Drive, Castaic, CA 91384 (661) 257-3855			U.S. EPA ID Number Not Required		
9. Waste Shipping Name and Description			10. Containers		11. Total Quantity
			No.	Type	12. Unit Wt./Vol.
1. Non-Hazardous Waste Solid (Soil)			001	DT	18 Y
2.					
3.					
4.					
13. Special Handling Instructions and Additional Information					
Soil: 99-100%		CCL Profile No.: CCL-16-137		Acct. No.: 1592	
Debris: 0-1%		AIS Project #: 36174			
Wear appropriate PPE when handling or as necessary					
14. GENERATOR'S/OFFEROR'S CERTIFICATION: I hereby declare that the contents of this consignment are fully and accurately described above by the proper shipping name, and are classified, packaged, marked and labeled/placarded, and are in all respects in proper condition for transport according to applicable international and national governmental regulations.					
Generator's/Offor's Printed/Typed Name CARRIE CROZIER on behalf of LAUSD - OEHS			Signature 		Month Day Year 7 13 16
15. International Shipments					
<input type="checkbox"/> Import to U.S. <input type="checkbox"/> Export from U.S. Port of entry/exit: Date leaving U.S.:					
16. Transporter Acknowledgment of Receipt of Materials					
Transporter 1 Printed/Typed Name ALFONSO SANDOVAL			Signature 		Month Day Year 7 13 16
Transporter 2 Printed/Typed Name			Signature		Month Day Year
17. Discrepancy					
17a. Discrepancy Indication Space: <input type="checkbox"/> Quantity <input type="checkbox"/> Type <input type="checkbox"/> Residue <input type="checkbox"/> Partial Rejection <input type="checkbox"/> Full Rejection					
Manifest Reference Number:					
17b. Alternate Facility (or Generator) U.S. EPA ID Number					
Facility's Phone:					
17c. Signature of Alternate Facility (or Generator) Month Day Year					
18. Designated Facility Owner or Operator: Certification of receipt of materials covered by the manifest except as noted in Item 17a					
Printed/Typed Name 			Signature 		Month Day Year 7 13 16



AMERICAN INTEGRATED SERVICES
ATTN: ACCOUNTS PAYABLE
PO BOX 92316
LONG BEACH, CA 90809

SITE	TICKET	GRID		WEIGHMASTER	
01	914515			ROSAL	
DATE IN	DATE OUT	TIME IN	TIME OUT	VEHICLE	ROLL OFF
07/13/16	07/13/16	9:59	9:59	A-GS101	
REFERENCE		ORIGIN			
16-137		LOS ANGELES			

Scale Gross Wt.	77780
Stored Tare Wt.	27000
Net Weight	50780

QTY.	UNIT	DESCRIPTION	RATE	EXTENSION	FEE	TOTAL
25.39	TON	Soil - Non Hazardous				

Note1: LAUSD
Note2: OEHS, 330 E. 3RD ST
Route: LOS ANGELES, CA 90003
PO Number 005-36174

SIGNATURE: _____

CHECK NO.

NON-HAZARDOUS WASTE MANIFEST		1. Generator ID Number Not Required	2. Page 1 of 1	3. Emergency Response 888-4180	4. Waste Tracking 006 - 301
5. Generator's Name and Mailing Address Los Angeles Unified School District - OEHS 333 S. Beaudry Ave., 21st Floor, Los Angeles, CA 90017 Generator's Phone: (213) 241-3199		Generator's Site Address (different than mailing address) LAUSD 1st Street Elementary School 330 E. 91st Street Los Angeles, California 90003			
6. Transporter 1 Company Name GIO SAND TRANSPORT		U.S. EPA ID Number			
7. Transporter 2 Company Name		U.S. EPA ID Number			
8. Designated Facility Name and Site Address Chiquita Canyon Landfill 29201 Henry Mayo Drive, Castaic, CA 91384 Facility's Phone: (661) 257-3655		U.S. EPA ID Number Not Required			
9. Waste Shipping Name and Description		10. Containers		11. Total Quantity	12. Unit Wt./Vol.
		No.	Type		
1. Non-Hazardous Waste Solid (Soil)		001	D7	18	Y
2.					
3.					
4.					
13. Special Handling Instructions and Additional Information Soil: 99-100% CCL Profile No.: CCL-16-137 Acct. No.: 1592 AIS Project #: 36174 Debris: 0-1% Wear appropriate PPE when handling or as necessary					
14. GENERATOR'S/OFFEROR'S CERTIFICATION: I hereby declare that the contents of this consignment are fully and accurately described above by the proper shipping name, and are classified, packaged, marked and labeled/placarded, and are in all respects in proper condition for transport according to applicable international and national governmental regulations.					
Generator's/Offor's Printed/Typed Name CARRIE CROZIER on behalf of LAUSD - OEHS		Signature [Signature]		Month Day Year 7 13 16	
15. International Shipments <input type="checkbox"/> Import to U.S. <input type="checkbox"/> Export from U.S.		Port of entry (ext.): Date leaving U.S.:			
16. Transporter Acknowledgment of Receipt of Materials					
Transporter 1 Printed/Typed Name ALFONSO SANDOVAL		Signature [Signature]		Month Day Year 7 13 16	
Transporter 2 Printed/Typed Name		Signature		Month Day Year	
17. Discrepancy					
17a. Discrepancy Indication Space <input type="checkbox"/> Quantity <input type="checkbox"/> Type <input type="checkbox"/> Residue <input type="checkbox"/> Partial Rejection <input type="checkbox"/> Full Rejection					
Manifest Reference Number:					
17b. Alternate Facility (or Generator)		U.S. EPA ID Number			
Facility's Phone:					
17c. Signature of Alternate Facility (or Generator)		Month Day Year			
18. Designated Facility Owner or Operator: Certification of receipt of materials covered by the manifest except as noted in Item 17a					
Printed/Typed Name		Signature		Month Day Year 7 13 16	



SITE	TICKET	GRID		WEIGHMASTER	
01	914808			ROSAL	
DATE IN	DATE OUT	TIME IN	TIME OUT	VEHICLE	ROLL OFF
07/13/16	07/13/16	13:45	13:45	A-GS101	
REFERENCE		ORIGIN			
16-137		LOS ANGELES			

Charge Ticket

Operating Hours:M-F 4:30AM to 5:00 PM, Sat 4:30AM-2:00PM		NET AMOUNT
Sunday-Closed		
I am responsible for damage and injuries.		TENDERED
Load has no liquids or hazardous waste		
Note1:	LAUSD	CHANGE
Note2:	OEHS, 330 E. 3RD ST	
Route:	LOS ANGELES, CA 90003	CHECK NO.
PO Number	006-36174	
SIGNATURE: 